

DESIGN SPECIFICATION: ANSI/TIA-222-G-2005 Add.2  
 BASIC WIND SPEED (No Ice): 44.44 m/s  
 BASIC WIND SPEED (With Ice): 18 m/s  
 DESIGN ICE THICKNESS: 0 mm  
 EXPOSURE CATEGORY: C  
 STRUCTURE CLASS: II  
 TOPOGRAPHIC CATEGORY: 1  
 IMPORTANCE FACTOR: 1.00

SECTION NO.	1	2	3	4	5	6	7
BOTTOM DIAMETER (mm)	1100.00	1022.53	941.95	858.15	770.99	680.35	586.07
TOP DIAMETER (mm)	963.93	886.46	805.88	722.08	634.92	544.27	450.00
WALL THICKNESS (mm)	10.00	10.00	10.00	10.00	10.00	10.00	10.00
LENGTH (m)	3.80	3.92	4.04	4.17	4.31	4.45	5.30
YIELD STRESS (MPa)	345	345	345	345	345	345	345
SECTION WEIGHT (kg)	1347	1245	1139	1028	914	794	670
CROSS SECTION	20-sided						

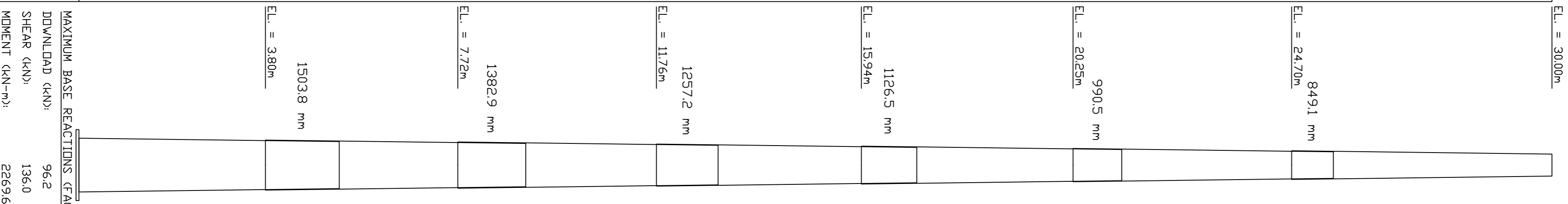

①  
②

ANTENNA LADING CHART								
PDS	DESCRIPTION	QTY	EL. (m)	T x LINE	QTY	AZIMUTH	COMMENTS	STATUS
1	WORK PLAT	1	30.00			0		
2	ANTENA LD-1	1	30.00	LDFSP-50A	12	0		
3	REST PLAT-1	1	15.00			0		

STATUS: E-EXISTING, F-FUTURE, P-PROPOSED

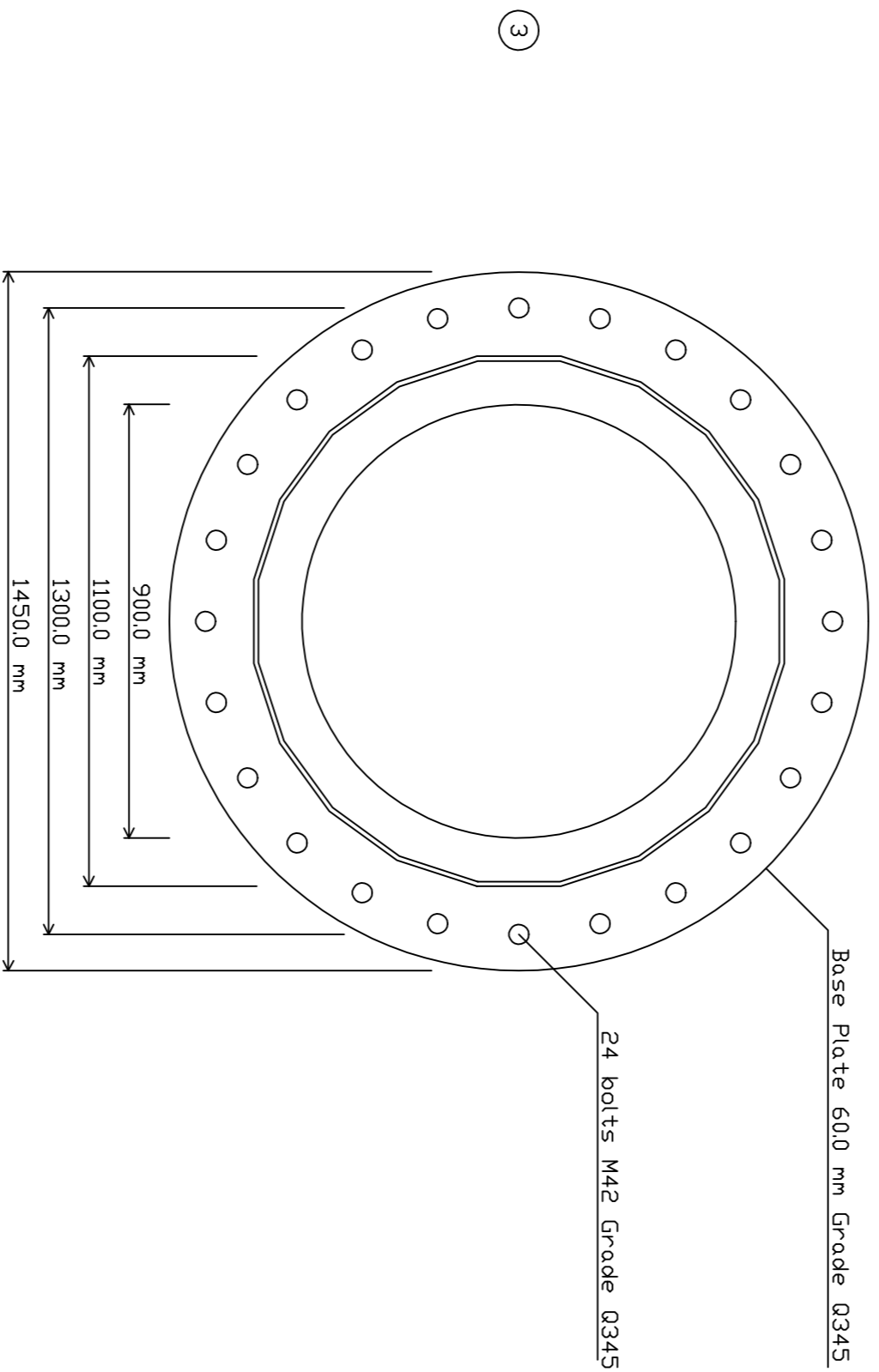

③

PROJECT TITLE		REV.
CONTRACT NO.	SITE NAME	1
CUSTOMER	ENGINEER	30M
DATE		